

## BORE THROUGH THERMOCOUPLE CONNECTOR

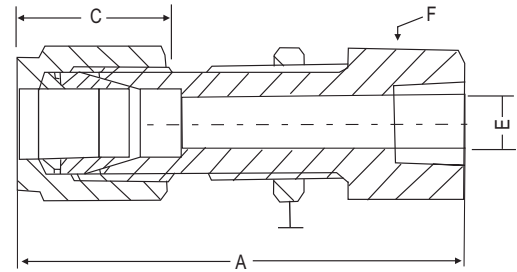

Dimensional Details :



Notes : Drawings are not to scale

Dimension, in.

Tube OD	NPT Female Thread Size	Part Number	A	C	E	F	Panel Hole Size	Max Panel Thickness
1/8	1/8	K2CFBH2N	1.76	0.50	0.09	9/16	21/64	0.50
1/4	1/8	K4CFBH2N	1.85	0.60	0.19	5/8	29/64	0.40
1/4	1/4	K4CFBH4N	2.04	0.60	0.19	3/4	29/64	0.40
3/8	1/4	K6CFBH4N	2.17	0.66	0.28	3/4	37/64	0.44
1/2	3/8	K8CFBH6N	2.43	0.90	0.41	15/16	49/64	0.50
1/2	1/2	K8CFBH8N	2.62	0.90	0.41	11/16	49/64	0.50

Dimension, mm.

Tube OD	NPT Female Thread Size	Part Number	A	C	E	F	Panel Hole Size	Max Panel Thickness
6	1/4	KM6CFBH2N	51.8	15.3	4.8	19	11.5	10.2
12	1/2	KM12CFBH8N	66.5	22.8	9.5	27	19.5	12.7

**Note:**

- A and C dimensions are typical finger-tight

Dimensions and specifications shown are approximate, may vary from time to time.

Ventil tube fittings are ordered by part numbers as listed in this catalogue and other sizes will be available on request.